



TECHNICAL DATA / FEATURES

- dimensions: φ161x112, φ161x115
- light functions: passing, driving, parking
- function markings: C/R, A, HC/R
- traffic: right-hand
- reference mark: 7.5, 12.5
- source of light: R2, T4W, H4
- maximum power: 55/50W, 4W, 75/70W
- nominal voltage: 12V-24V DC
- optics: standard
- IP rating: IP55
- housing's material: plastic, metal
- lens' material: glass
- built-in connectors: -
- other (optional): metal housing



ADDITIONAL INFORMATION

Particularly recommended for tractors and slow-moving vehicles.

Possible installation as: left-side, right-side or in vertical position using 18mm, steel, zinc plated bushing (supplied). The wiring runs through the length of the mounting bolt.

Useful parts while installing:

- main bulb gasket - cat. No. A.05820
- parking light bulb holder - cat. No. A.05921
- main bulb mounting block - cat. No. A.07128

Dedicated application:

- A - tractors:
 - Ursus: C-300, C-400
 - Zetor: 2011, 3011, 3511, 4011, 6711
 - Pronar Zubron 2032A
- A - electric vehicle Melex 252

DIMENSIONS

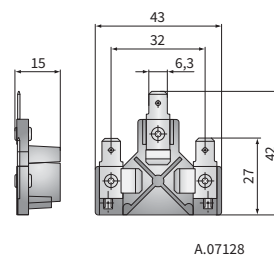
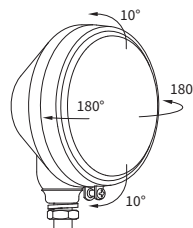
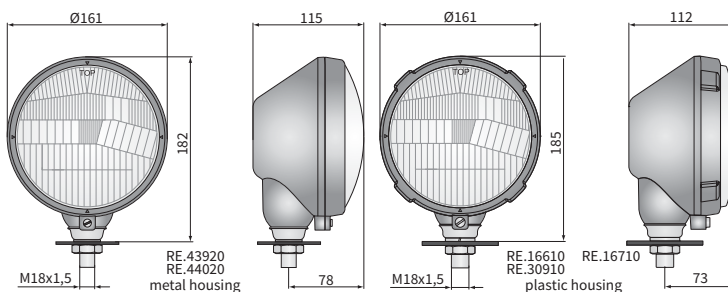

A.07128

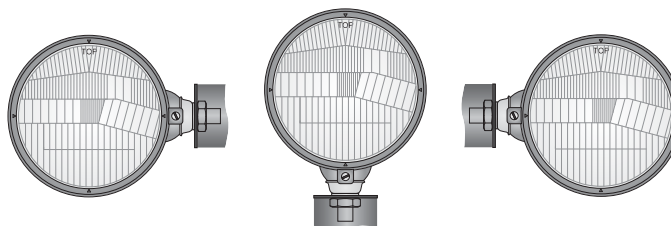

Cat. number	Homologation code	Light functions			Type	R2	H4	Accessories		Housing material	plastic	metal	Mounting method			Application	dedicated	
		passing	driving	parking				bulb R2,12V	bulb T4W				side - right	side - left	installed vertically up			
RE.13910	032	✓	✓	✓		✓				✓			✓				A	
RE.16510	212	✓	✓	✓			✓			✓				✓				A
RE.03210	032	✓	✓	✓		✓				✓					✓			A
RE.21210	212	✓	✓	✓			✓			✓						✓		A
RE.16710	032	✓	✓	✓		✓				✓						✓		A
RE.30910	032	✓	✓	✓		✓		✓	✓	✓						✓		A
RE.16610	212	✓	✓	✓			✓			✓						✓		A
RE.44010	032	✓	✓	✓		✓				✓	✓							A
RE.43910	212	✓	✓	✓			✓			✓	✓			✓				A
RE.44000	032	✓	✓	✓		✓				✓	✓				✓			A
RE.43900	212	✓	✓	✓			✓			✓	✓				✓			A
RE.44020	032	✓	✓	✓		✓				✓	✓					✓		A
RE.43920	212	✓	✓	✓		✓				✓	✓				✓			A