



TECHNICAL DATA / FEATURES

- dimensions: 196x95x76
- light functions: fog light, driving
- function markings: B, HR
- reference mark: -, 17.5
- source of light: H3
- maximum power: 70W
- nominal voltage: 12V-24V DC
- optics: standard
- IP rating: IP54
- housing's material: metal
- housing's colour: black, metal, chrome-plated
- lens' material: glass
- lens' colour: clear
- mounting: M10
- built-in connectors: -
- other (optional): bracket and screws made of Inox steel



ADDITIONAL INFORMATION

To be mounted at the front of the car or truck. They can be installed in an upright or upside down position.

E8 approval mark refers to halogen driving lights and E11 mark refers to halogen fog lights.

In chrome-plated version, the housing is made of brass sheet and bracket parts are made of Inox steel.

It is possible to install needed connectors on wire (on request).

Dedicated application:

A - Lublin I (from 1993)

DIMENSIONS

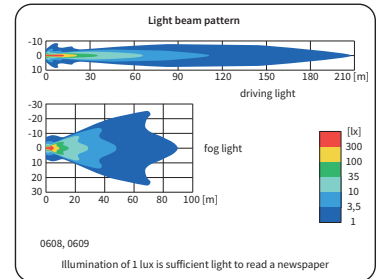
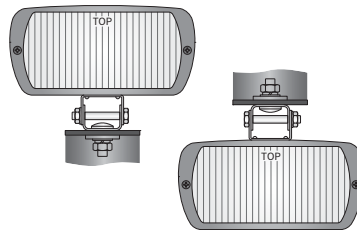
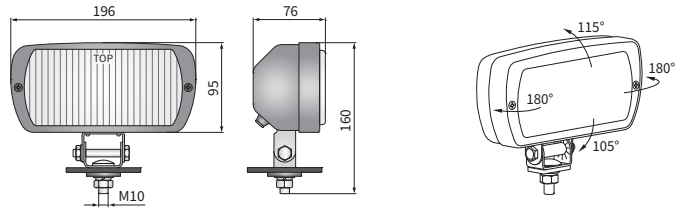

Cat. number	Homologation code	Light functions		Lens colour		housing	black	chrome-plated	Accessories	bulb H3 12V	bulb H3 24V	Mounting method		Side	right	left	Connectors	AMP Faston 250	Deutsch DT	AMP SuperSeal 1,5	Application		Packaging / pc	carton box
		fog light	driving	clear	amber							installed vertically up	suspended								universal	dedicated		
0608.43810	001	✓		✓			✓					✓		✓	✓						✓		1	
0608.43820	001	✓		✓			✓					✓		✓	✓						✓	A	1	
0609.44710	003		✓	✓				✓				✓	✓	✓	✓						✓		1	