



TECHNICAL DATA / FEATURES

- CAR1 series bracket - clamp connector made of plastic
- female clamp connector
- bracket and screws made of Inox steel
- for shaft diameter $\phi 24$ mm
- CAR2 series bracket - clamp connector made of plastic
- bracket and screws made of Inox steel
- for pipe diameter 15÷28 mm
- CAR3 series bracket - clamp made of aluminum alloy
- bracket and screws made of Inox steel
- for shaft $\phi 30$ mm (DIN 14640)
- CAR4 series bracket - neodymium magnet
- in set: washers, nuts and bolts
- CAR5 series bracket - suction cup



ADDITIONAL INFORMATION

They help to install work lamps in untypical and hard-to-reach areas on the vehicle.

For heavy work lamps, it is recommended to use magnetic holder with 2 magnets.

Equivalents for Hella:

CAR1.47300 - 8HG 990 320-001

CAR2.49100 - 8HG 990 263-111

CAR4.51301 - 8HG 004 806-001

Dedicated application:

A - work lamps of LED serie

B - work lamps

C - tractors Case: IH, CS, CVX, JX, MAGNUM, MX, MXM

D - work lamps for fire-fighting vehicles

E - work lamps of CRC5 serie

DIMENSIONS

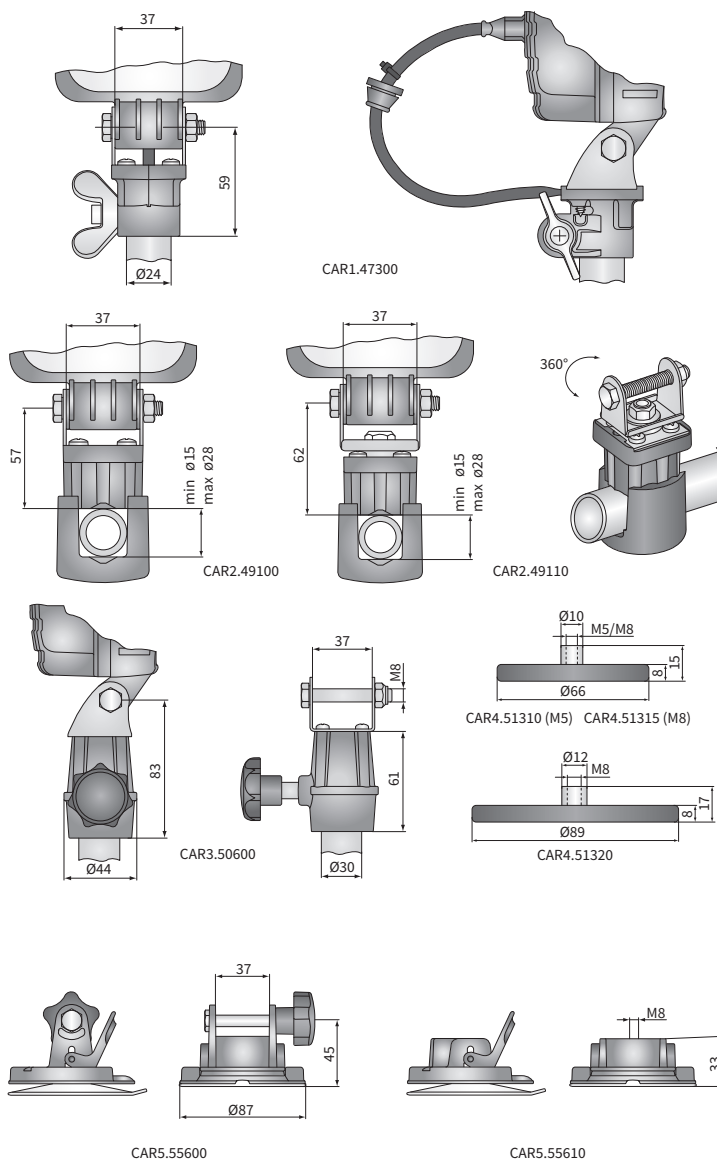

Cat. number	Type	on the shank	on the pipe	neodymium magnet	suction cup	Diameter	Lifting capacity	Accessories	Bracket	Application
CAR1.47300		✓				$\phi 66$	230N	✓	M5	A
CAR1.47301		✓				$\phi 87$	500N	✓	M6	A
CAR2.49100			✓			$\phi 89$		✓	M8	A/C
CAR2.49110			✓					✓		A/D
CAR3.50600		✓						✓		D
CAR4.51310			✓				✓		✓	A/B
CAR4.51312			✓				✓		✓	B
CAR4.51315			✓				✓		✓	A/B
CAR4.51330			✓				✓		✓	B
CAR4.51320			✓				✓		✓	A/B
CAR5.55600				✓						E
CAR5.55610				✓						